

ORIGINAL

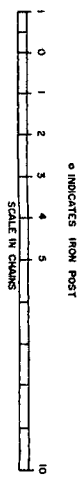
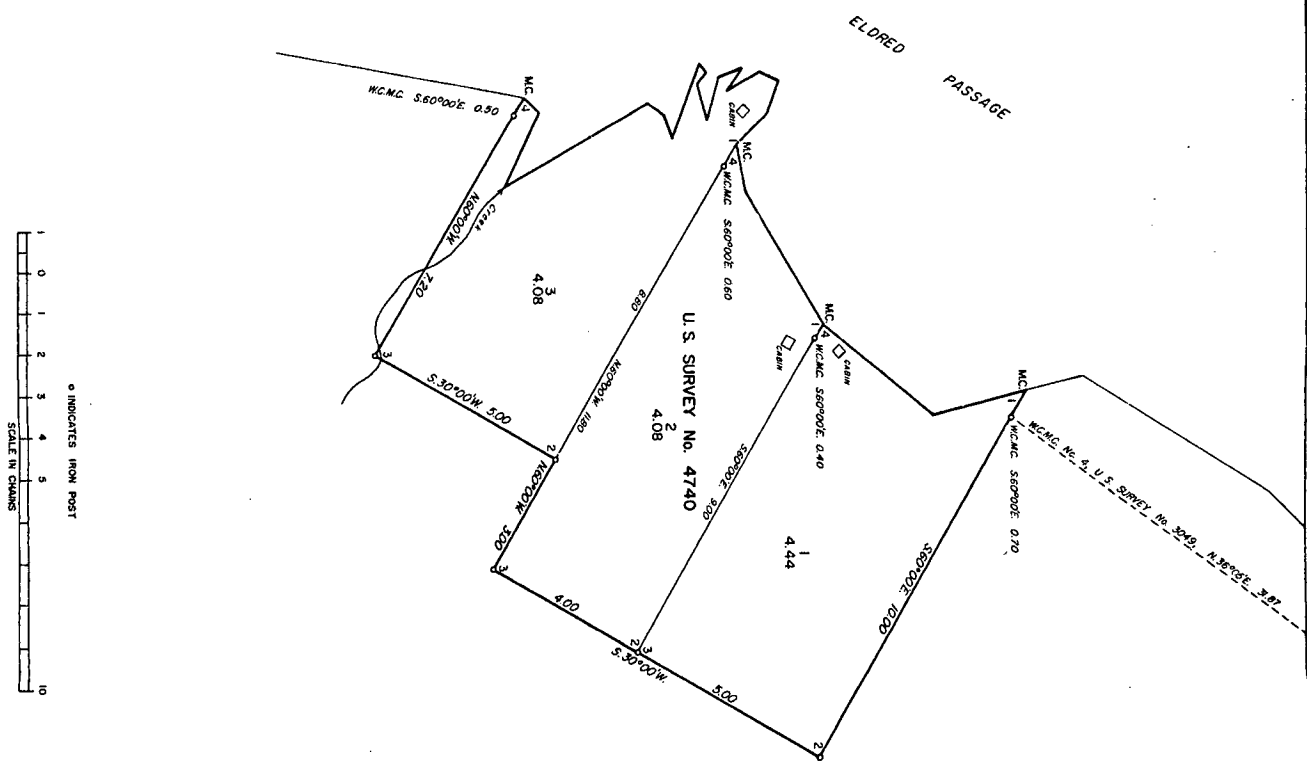

U. S. SURVEY
 No. 4740, ALASKA
 EMBRACING
 LOTS 1 THROUGH 3

SITUATED
 ON THE EASTERN SHORE
 OF ELDRED PASSAGE
 KACHEMAK BAY

APPROXIMATE GEOGRAPHIC POSITION
 AT WITNESS MEASUREMENT CORNER NO. 1, LOT 1
 LATITUDE 59° 31' 10" N., LONGITUDE 151° 26' 45" W.

AREA: 12.60 ACRES

SURVEYED BY:
 ROBERT B. HARTY, SUPERVISOR, CADASTRAL SURVEYOR
 SEPTEMBER 22 TO SEPTEMBER 26, 1964

Under Special Instructions
 Dated April 14, 1964, and
 Approved April 17, 1964

UNITED STATES DEPARTMENT OF THE INTERIOR
 BUREAU OF LAND MANAGEMENT
 Washington, D. C. July 21, 1966

This plat is strictly conformable to the approved survey and the surveying notes have been directly associated in accordance with the requirements of law and the regulations of this Bureau, as hereby accepted.

For the Director
[Signature]
 Chief, Division of Engineering

5/16/66 (c-4)